

## Step 6: Attach the Valance

Velcro the valance to the front of the track. For an Outside Mount, when the unit is hung on the wall above the window, the ends of the valance are creased and meant to be folded over to form valance returns.

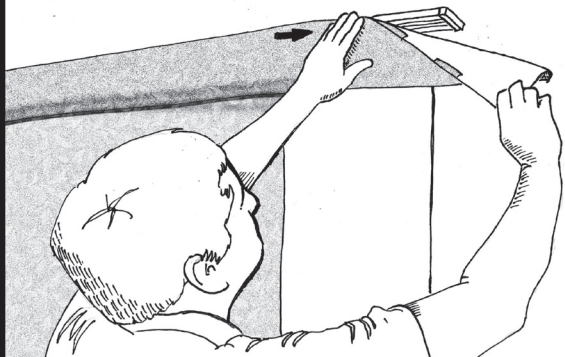

**Installation is now Complete**

B&W Window Fashions  
Waukegan, Illinois

## Warranty

B&W Window Fashions warrants that its Horizons products - properly installed in a residential dwelling will be free from defects in materials and workmanship for as long as the original purchaser owns the product. All fabric colors tend to lose their original intensity over time, and pull cords eventually wear out. This is considered normal wear and tear and is not covered by this warranty. Abuse and misuse are not covered. Color lots vary and may not exactly match a previously ordered product. Repair is the purchaser's sole remedy under this guarantee. This warranty does not cover incidental or consequential damages, installation or service calls.

## Warning

Young children can STRANGLE in cord and bead chain loops. They can also wrap cords around their necks and STRANGLE.

- Always keep cords and bead chains out of children's reach.
- Move cribs, playpens, and other furniture away from cords and bead chains. Children can climb furniture to get to cords.
- Attach a cord guide to the wall. This can prevent children from pulling cords and bead chains around their necks.



## INSTALLATION INSTRUCTIONS FOR

Horizons™  
by B&W

## Élance Sliding Panels



Congratulations on the  
purchase of your new  
Shades of Elegance™ Élance.

Horizons™  
by B&W

## Step 1: Install Brackets (OM)

### Outside Mount

Install the brackets approximately  $\frac{1}{2}$ " higher than the unit's finished height. For example, if the Élance™ was ordered 84" tall, mount the tops of the brackets  $84 \frac{1}{2}$ " above the floor.

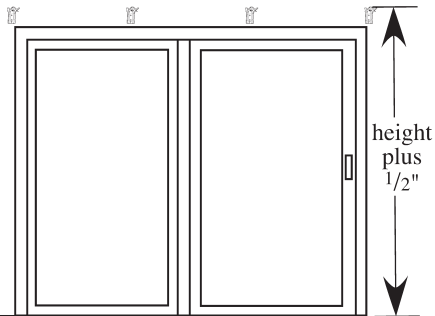

The two brackets on the end should be positioned within 4" of the end of the track. Space additional brackets evenly. Mount all brackets level at the same height.

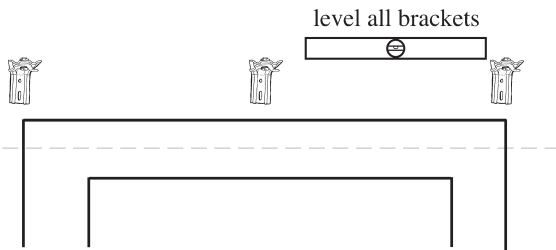

Be sure to also use all of the brackets provided. A level and well supported track will ensure smooth operation.

## Step 2: Install Brackets (IM)

### Inside Mount

Install the brackets no more than  $\frac{7}{8}$ " back from the window opening. The two brackets on the end should be installed within 4" of the end of the track. Space additional brackets evenly.

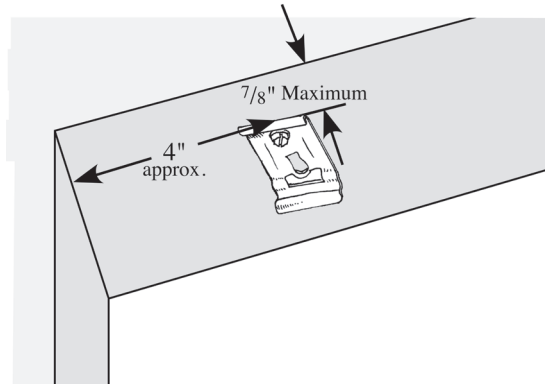

## Step 3: Install the Track

Insert the middle lip on the track into the front lip of the bracket, then snap the back into place.

Insert Middle Lip into Front Lip of Bracket

Snap in Place

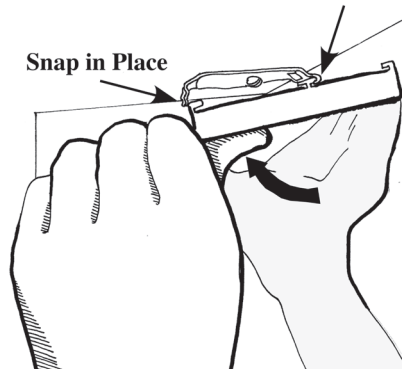

## Step 4: Hang the Panels

Velcro one panel onto each of the track's carriers. Care should be taken to position the panels level and firmly in place. The carriers can be disengaged from one another for easier installation by sliding them apart while pressing the back carrier towards the wall.

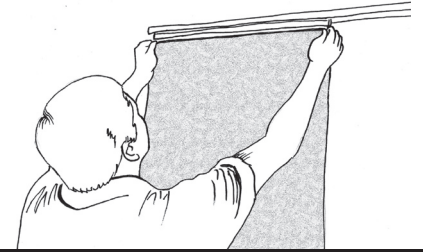

## Step 5: Attach the Cord Tensioner

### IMPORTANT

In compliance with national safety regulations shades will not operate unless the cord tensioner is installed correctly! After the shade is installed, the cord tensioner must be secured to the wall.

1. Locate the tensioner as close to the shade as possible without interfering with the shade.

2. Make sure the screw hole (A) on the cord tensioner is pulled half way down before mounting. This will ensure the cord can move freely through the cord tensioner.

3. For IM installations attach the cord tensioner directly with a screw through the screw hole. For OM installations use the supplied mounting bracket (B).

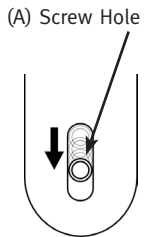

(B) Mounting Bracket

